

IFE-PC

Heavy-Duty Pipe Clamps



www.ife-group.com



IFE's heavy-duty pipe clamps are as versatile as they are strong. They deliver exceptional clamping force, and with a simple modification make great pipe hangers (in exhaust applications, for example). Choose from over 30 diameters and 3 band widths.

- Ideal solution for exhaust applications and more
- Corrosion-resistant zinc finish (hexavalent chromium-free)
- Heavy-duty design & materials
- Easily modified for pipe hanging
- Rugged band withstands high vibration for pipe clamping
- Can be used with M8, M10 or M12 bolt (size-dependent)
- 3 band widths available (size-dependent)



IFE Americas is a global provider of sealing and retaining solutions to meet customer needs. We offer a wide range of clamps, couplings, straps, and sleeves, with in-house testing facilities and technical support.



IFE-PC: Heavy-Duty Pipe Clamps



www.ife-group.com

IFE Part Number	Restrained Diameter (D ₁)	Pipe O.D.	Bolt Hole Center to Top of Flat (C)	Bolt Hole Diameter (D ₂)	Bolt Hole Center to Top of Curve (E)	Clamp Center from Top (F)	Material Width (A) x Thickness (B)
17015429010030	30.2	30	10	8.4	8	28	20 x 2
17015429010032	32.2	30	10	8.4	8	29	20 x 2
17015429010035	35.2	35	10	8.4	8	30.5	20 x 2
17015429010037	37.2	35	10	8.4	8	31.5	20 x 2
17015429010040	40.3	40	16	8.4	14	33.5	25 x 3
17015429010042	42.3	40	16	8.4	14	34.5	25 x 3
17015429010045	45.5	45	16	8.4	14	36.5	25 x 3
17015429010048	48.5	45	16	8.4	14	38	25 x 3
17015429010050	50.5	50	16	8.4	14	38.5	25 x 3
17015429010053	53.5	50	16	8.4	14	40	25 x 3
17015429010055	55.5	55	16	8.4	14	41.5	25 x 3
17015429010058	58.5	55	16	8.4	14	43	25 x 3
17015429010060	60.5	60	16	8.4	14	44	25 x 3
17015429010063	63.5	60	16	8.4	14	45.5	25 x 3
17015429010065	65.5	65	16	8.4	14	46.5	25 x 3
17015429010068	68.5	65	16	8.4	14	48	25 x 3
17015429010070	70.5	70	17	10.5	15	50.5	30 x 4
17015429010073	73.5	70	17	10.5	15	52	30 x 4
17015429010075	75.5	75	17	10.5	15	53	30 x 4
17015429010078	78.5	75	17	10.5	15	54.5	30 x 4
17015429010080	80.5	78	17	10.5	15	55.5	30 x 4
17015429010083	83.5	85	17	10.5	15	57	30 x 4
17015429010085	85.5	85	17	10.5	15	58	30 x 4
17015429010089	89.5	85	17	10.5	15	60	30 x 4
17015429010090	90.5	90	17	10.5	15	61	30 x 4
17015429010094	94.5	90	17	10.5	15	63	30 x 4
17015429010100	100.5	100	17	10.5	15	66	30 x 4
17015429010105	104.5	100	17	10.5	15	68	30 x 4
17015429010110	110.5	110	19	13	17	75	30 x 4
17015429010114	114.5	110	19	13	17	77	30 x 4
17015429010120	120.5	120	19	13	17	85	30 x 4
17015429010124	124.5	120	19	13	17	87	30 x 4

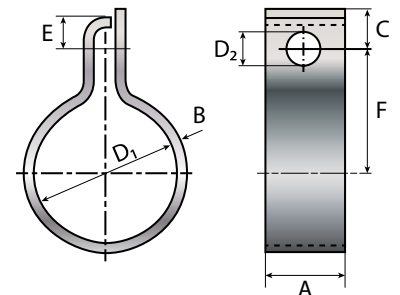

Heavy-duty pipe clamp or hanger, restrained condition

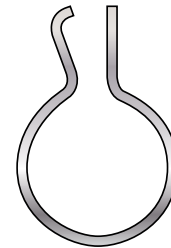

Standard clamp, shipping condition

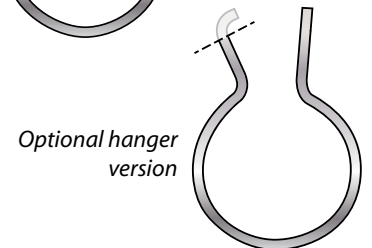

Optional hanger version

Due to our program of continuous improvement, specifications may be subject to change.

All sizes in mm

Material: ASTM A283C-A structural steel

Coating: Zinc with trivalent silver chromate (hexavalent chrome-free)

Due to our program of continuous improvement, specifications may be subject to change.

IFE Americas USA

12877 Emerson Drive, Suite 200
Brighton, MI 48116

Phone: +1 (248) 446-1900

E-mail: info@ife-group.com

IFE Americas México

Bernardo Quintana 7001 Torre 2 – 813
Col. Centro Sur. Querétaro, Qro. 76090

Phone: +52 (442) 245-1515

E-mail: info@ife-group.com

IFE Europe Sweden

Banérgatan 51
SE-115 22 Stockholm

Phone: +46 708 102 711

E-mail: info@ife-group.com

